



Schloss Lindich Golf Hotel & SPA

Burg Hohenzollern, view from Schloss Lindich



The hunting castle Schloss Lindich, so much beloved by the Princess Eugénie de Beauharnais, is in front of Burg Hohenzollern, the Kaiser Wilhelm's residence.

Our property is located right in front of Germany's Burg Hohenzollern, the most important Castle of the German Royal Family. About 300.000 people visit the Royal Castle every year. The Golf Hotel & SPA will be placed in the quiet area of Schloss Lindich, a pleasant rococo style villa belonging to the German Crown for hundred of years. Here sojourned, among others, Liszt, Berlioz, and the French Emperor Napoleon III. It is a paradise for the lovers of nature and tranquillity. It is located in the enchanting forest, surrounded by lovely Swabian hills and vineyards.

Nearby you have access to exclusive 32 hole golf courses, tennis fields and a riding school. The former German Emperor once said: "the landscape of this area is worth a long journey". In front of this beautiful natural resort, so full of history and charm, we are sure you will feel delighted like a King !

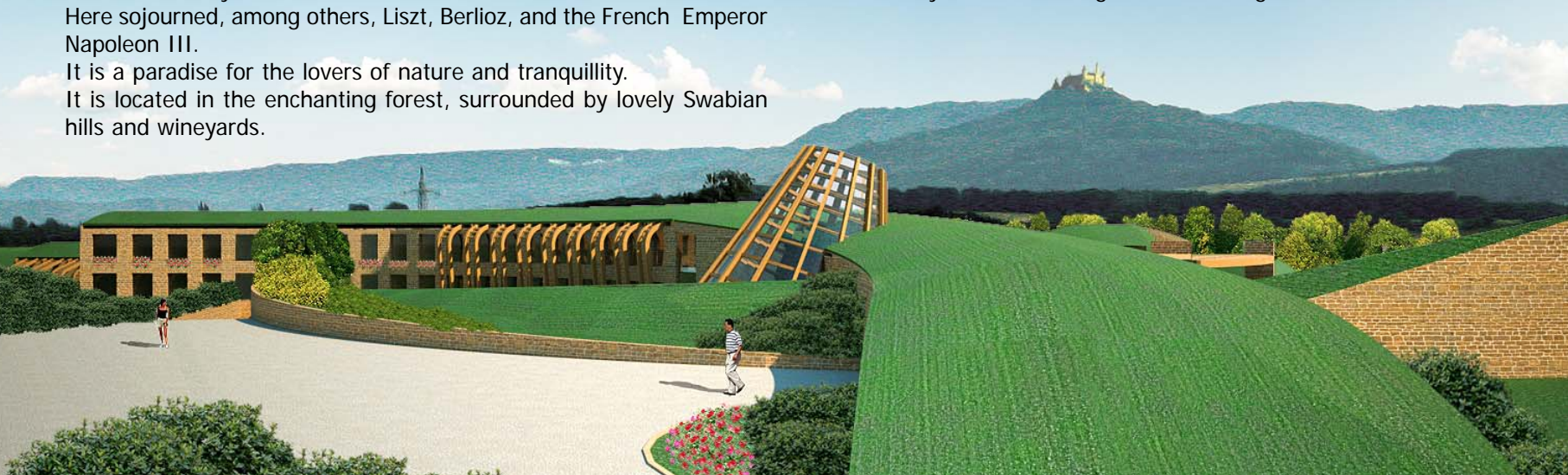

Schloss Lindich, Middle Europe

Welcome to the Castle of Lindich !

The Castle of Lindich is located in Baden-Württemberg, Germany, between the French and the Swiss borders.

Lindich lies in the very heart of old Europe : just an hour and half from Zurich, Strasbourg, Munich and Frankfurt, in the Stuttgart area.



Schloss Lindich & Our Project Property - Actual



Our Project Property extends
on 3 hectares land.

n.8 buildings = 3.800 sqm

... The building lies in the wild nature allowing a perfect integration with the surroundings. Its sinuous, curvy shapes avoid to make it appear like an excessive compact mass. Moreover, the structure reminds a DNA double helix, conversing into an evoked cosmic symbolism. It shifts from a neoclassical style to a modern radial one.

The single and double rooms and the two sided lodgings are assigned to the stay of families. A third typology of apartments is supplied with five small isolated villas delimited by a small lake. The arched shape determines non rectilinear corridors, which are pleasant and not monotone. The rooms convey visual widths projected towards the landscape.

The greater part of this structure is oriented towards South. The top of the building, together with its surrounding shapes, will be covered with vegetation, as remembrance of the surrounding hills. The green roof in fact remarkably improves the thermal characteristics of the structure, and it also pursues the aesthetic aim of a landscape blended with the architecture...

*Luigi Prestinenza Puglisi
Professor of History of Modern Architecture
at University of Rome
from "Ilsole24ore - Edilizia e Territorio" - march 2007*



Schloss Lindich & Our Project Property

Approved!

We have received the authority approval to build :

- n.1 Hotel + Wellness Center
- n.1 Residence
- n.5 Villas

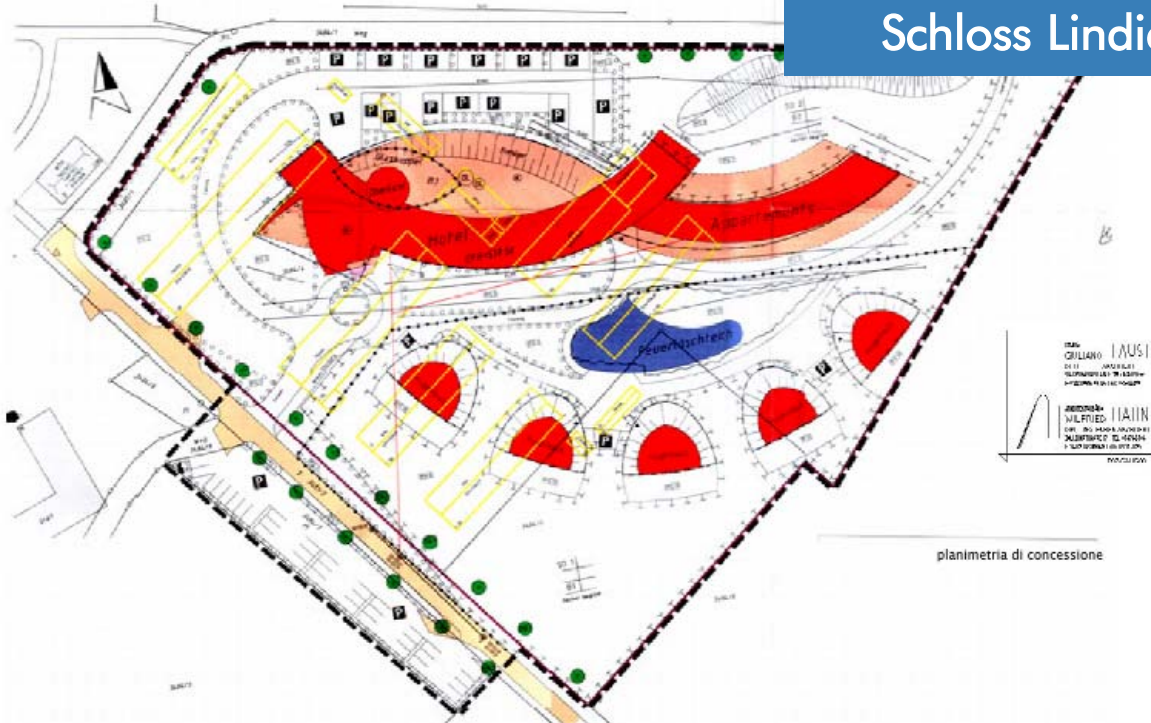

Schloss Lindich Golf Hotel & SPA - Entrance



An architectural rendering of a modern residence at the Schloss Lindich Golf Hotel & SPA. The building features a prominent, curved, dark brown wooden structure with horizontal slats, set against a brick wall. A person is walking on a path in the foreground, which is bordered by a low wall and a bed of colorful flowers. In the background, there are lush green bushes and a traditional red-roofed house.

Schloss Lindich Golf Hotel & **SPA** - Residence + View

Our project

Approved!

Residence

n.13 Apartments x 176 sqm
= 2.288 sqm + garden + u.g.

Villa

n.5 Villas x 197 sqm
= 985 sqm + garden + u.g.

Hotel

Hall - Reception
n.56 Rooms

= 3.144 sqm

Meeting Area

Congress Center + Restaurant
= 2.733 sqm

Wellness

Total Area = 1.292 sqm

Schloss Lindich Golf Hotel & SPA



Schloss Lindich Golf Hotel & SPA

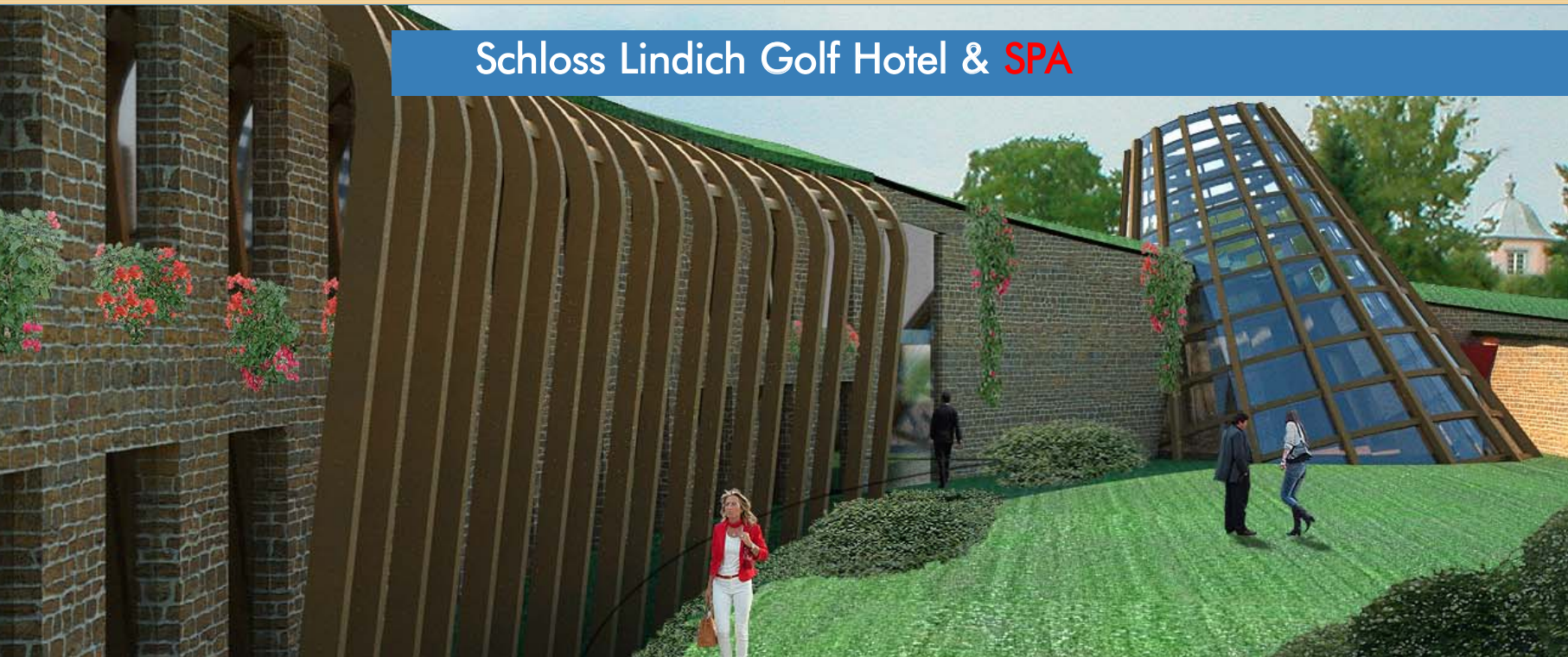

Schloss Lindich Golf Hotel & SPA



Schloss Lindich Golf Hotel & **SPA** - Residence, 13 Apartments

Residence - Total surface: 2.288 sqm

n.13 Apartments

- ground floor surface 176 sqm
- underground 96 sqm

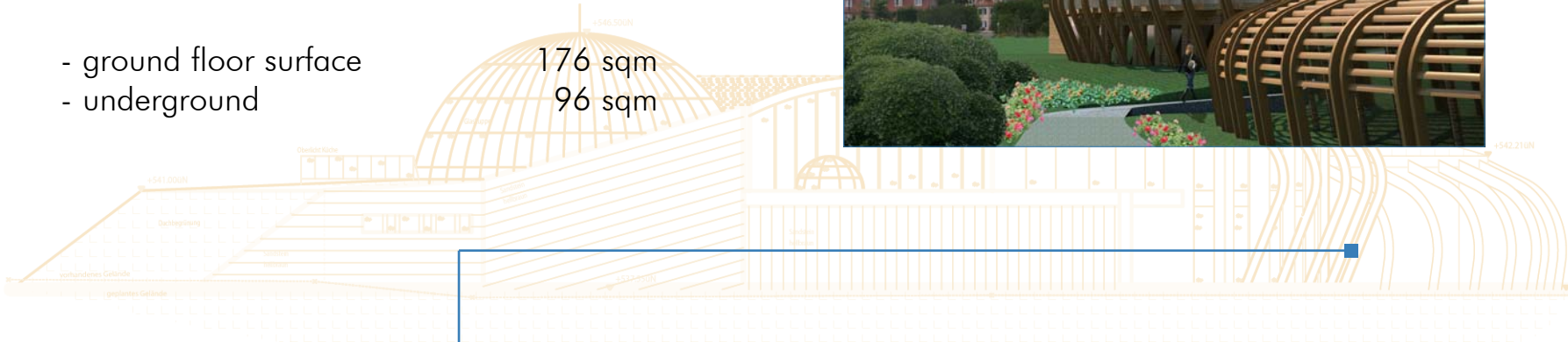

Schloss Lindich Golf Hotel & SPA - Ground floor + Villa Surface

EG= Ground Floor	2.040 sqm
Restaurant	538 sqm
Hall	410 sqm
n.16 Single Room	265 sqm
n.12 Double Room	287 sqm
n.13 Apartments	540 sqm
n.1 Villa:	197 sqm x n.5 = 985 (*) sqm
n.1 Villa:	494 m ³ x n.5 = 2.471 m ³
(*) (EG _{Ground Floor} = 147 sqm + OG _{First Floor} = 50 sqm)	



Schloss Lindich Golf Hotel & SPA Underground Surface

Hotel + Residence (n. 13 Apartments)

UG = Underground 4.000 sqm

0.0	Hall	120 sqm
0.1	Conference Area	1.335 sqm
0.2	Wellness	1.214 sqm
0.3	Apartments	1.267 sqm



Schloss Lindich Golf Hotel & SPA

- First Floor Surface + Total surf. 3 levels (L3v3Ls)

OG= First Floor 1.377 sqm

Services/Shops 344 sqm

n.16 Single Rooms 265 sqm

n.12 Double Rooms 287 sqm

n.13 Apartments 481 sqm

Total Surface = (7.353 + 985) sqm = 8.338 sqm

Total Volume = (33.000+ 2.471) m³ = 35.471m³



Schloss Lindich Golf Hotel & SPA - Total Surfaces and Volume



HOTEL + Residence		
UG	[Underground Floor]	3.937 sqm
EG	[Ground Floor]	2.040 sqm
OG	[First Floor]	1.376 sqm
Grand Total		7.353 sqm = 33.000 m ³

Schloss Lindich Golf Hotel & SPA - Hotel Interior



Golf Hotel Resort & SPA - Villa and Apartment Drawings

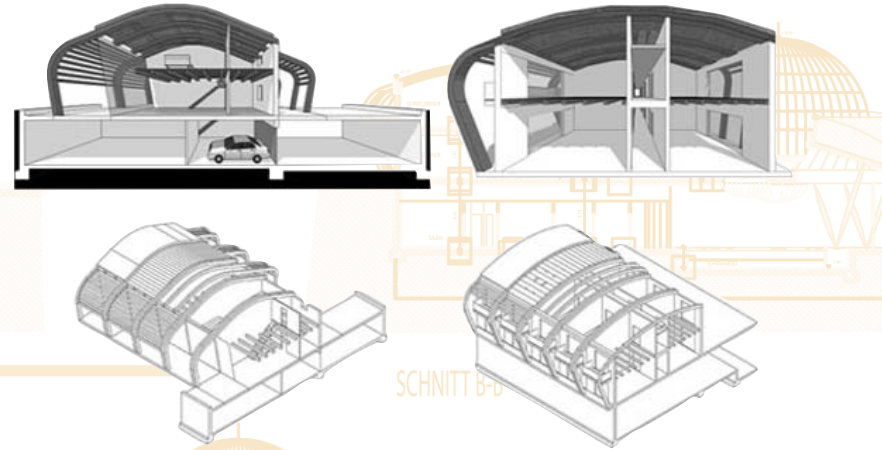
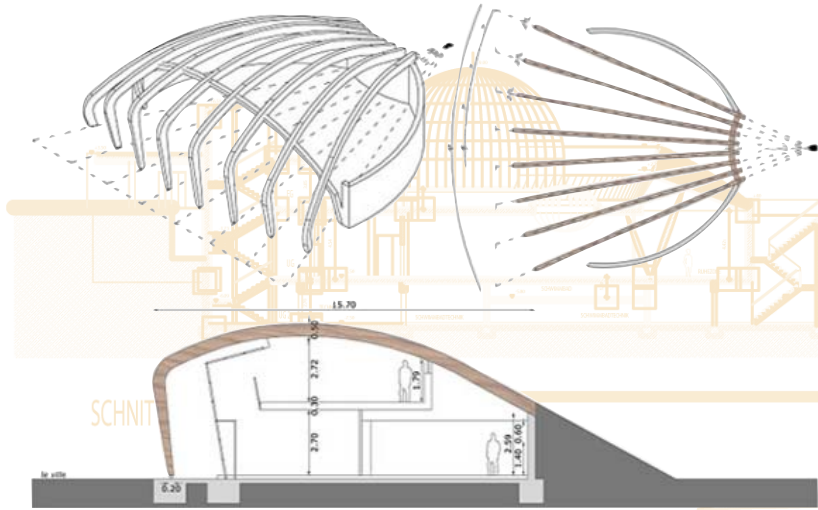

Golf Hotel Resort & SPA - Project Model and Drawing



Neighbourhood



32 Holes
Golf Club
Honnzollern



Endurance
International
Tournament
& Horse Riding Club



Project Integration - Satellite Google modified View

Our Project is not only a leisure, historical, business, cultural operation [Berlioz, Liszt, Lenné were usual Schloss Lindich guest] but also it is a great architectural development for the integration between past and future.

Architects:

Giuliano Fausti, Rome
www.faustistudio.com

Wilfried Hahn, Hechingen
www.Architektur-Hahn.de



Maps - Satellite Google View



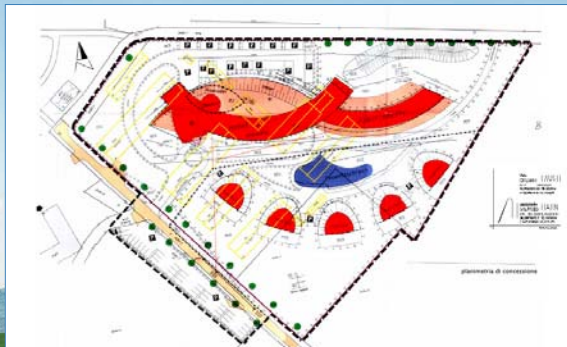

info@schlosslindich.com
www.schlosslindich.com

Thanks for your attention